

## General

HTW-WF01-FC series Smart Wifi fan coil thermostat is widely used in these environment like Homes, Residential buildings, Schools, Hotels, Hospitals, Offices and etc. to main an ideal room temperature purpose.

## Features

- 17 Mainstreaming Languages synchronize in APP(English, Spanish, Russian, Hungarian, Turkey, Hebrew, German, Italian, Japanese, French, Poland, simplified Chinese, traditional Chinese, Holland, Portuguese, Vietnamese, Arabic, Korean)
- Snap-In Easy Installation
- Fit for EU & Standard Junction Electric Box
- Easily Work with Amazon Alexa, Google Assistant, IFTTT

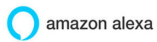

- Group Control in 1 App
- Fashion Sense of Science and Technology

## Ordering Guide

HTW-WF01- FC-**	-2	2 pipe(tube) system	-W	Window Card input
	-4	4 pipe(tube) system	-T	Clock
Smart Wifi Fan Coil Thermostat	-M	Modulating output	-P	Programmable
	-N	Modbus RTU communication	-E	External Temperature Sensor
	-K	Key Card occupancy input	-24v	Power Supply with 24Vac

e.g. HTW-WF06-FC-2KP refers to application: 2 pipe(tube) system, 3 fan speed + 1 H/C valve, with key card and weekly programmable

## Typical Wiring

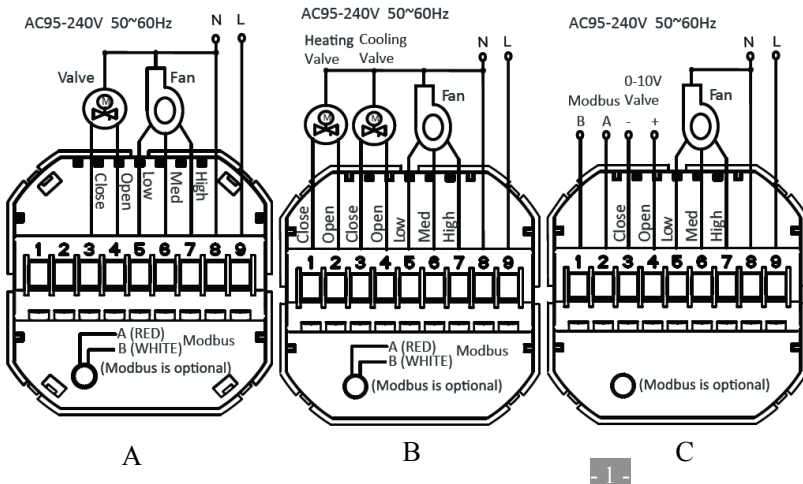

**A=HTW-WF01-FC-2**

--2 pipe(tube) system

--3-speed fan

-1 NO/NC valve

**B= HTW-WF01-FC-4**

--4 pipe(tube) system

-3-speed fan

-2 NO/NC valve

**C=HTW-WF01-FC-MN**

--3-Speed fan output

--1 load of Modulating 0~10V output

--Modbus Communication

**Specification**

<b>Power Supply</b>	95~240Vac, 50/60Hz	<b>Sensor</b>	NTC3950, 10K
<b>Current Load</b>	Fan Relay 5A(3A-inductive)	<b>Temperature Accuracy</b>	±0.5°C or ±1°F
	Valve Relay 3A(1A-inductive)	<b>Set-Point Range</b>	5~35°C
<b>Storage Temp.</b>	-5 ~ 45 °C	<b>Display Temp. Range</b>	5 ~ 99°C
<b>Power Consumption</b>	< 1.5W	<b>Timing Error</b>	< 1%
<b>Housing Material</b>	PC +ABS ( Fireproof)	<b>Installation Box</b>	EU or Standard Electric Box
<b>Wires on Terminals</b>	Wire 2 x 1.5 mm <sup>2</sup> or 1 x 2.5 mm <sup>2</sup>		
<b>Protection Class</b>	IP20	<b>Operating Buttons</b>	Capacitive Touch Buttons

**Installation**

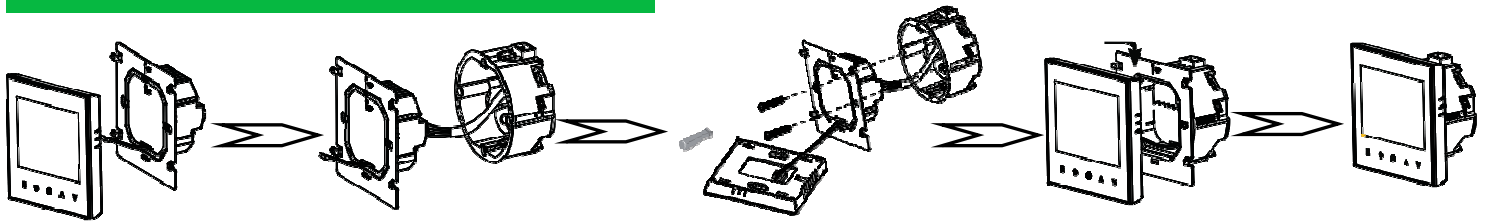

**WARNING: RISK OF ELECTRICAL SHOCK.** Disconnect power supply before making electrical connection. Contact with components carrying hazardous voltage can cause electrical shock and may result in severe personal injury or death.

- Make sure the power is OFF! Try turning ON your heating/cooling system by changing the temperature. If you can't get the system to turn ON in 5 minutes, you'll know the power is OFF.
- Take off the installation faceplate by rotating and gently pulling, then connect voltage supply/load output/external sensor(if with) wires respectively to appropriate terminals.
- Fix the installation plate onto the electric junction box with screws packed in the box.
- Fasten the thermostat display part and the installation faceplate through the groove.(Installation process completed)

**Dimensions and Display**

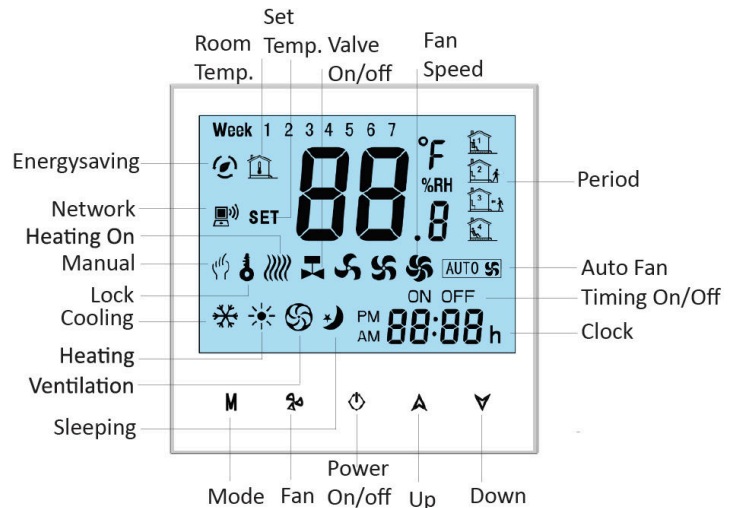
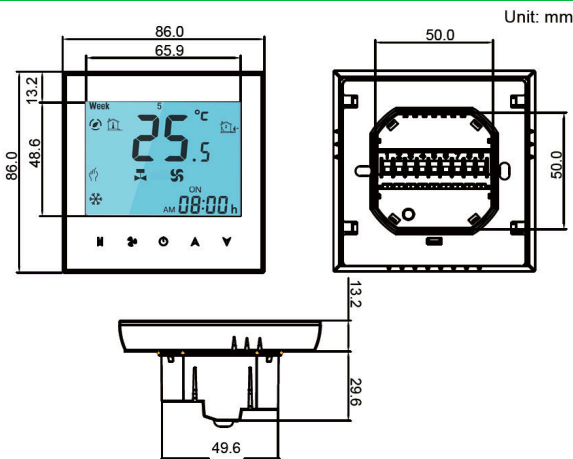



**Operation**

Buttons/Functions	Operation																																							
	Switch thermostat power On or Off																																							
	Increase or decrease set-point or parameters																																							
	Select the Fan Speed in Auto-High-Medium-Low-Auto																																							
Lock/Unlock	Press these 2 buttons  simultaneously and hold for 5 seconds to lock/unlock thermostat. <i>Notes: In parameter 3 of ISU process, Full/Half lock configurable.</i>																																							
M	Switch between Manual and Programmable mode In manual mode, this icon appears in the button left display In programmable mode, the period icon appears in the right side. <i>Notes: In programmable mode, the Temperature and Time can not be adjusted</i>																																							
Programmable Schedule Configuration (5+2 weekly)	<p>1.Press <b>M</b> button switch working mode to Programmable mode.</p> <p>2.Set the time and weekday: Touch M and hold for seconds to set Minute&gt;Hour&gt; Weekday (1 = Monday, 2 = Tuesday etc.) Increase or decrease parameters by using these icons  . Press <b>M</b> once more to confirm and switch to next relevant parameter setting.</p> <p>3. Touch the icon <b>M</b> again to set the weekday schedule [settings appear (1 2 3 4 5) will show along the top of the screen]. Likewise, use  and <b>M</b> becomingly to adjust the time/temperature for the 1-6 period per day. Repeat the above process to set the weekend schedule. Press <b>M</b> once more to confirm and exit.</p> <p style="text-align: center;"><b>Ex-factory Default Settings</b></p> <table border="1"> <thead> <tr> <th rowspan="2">Time display</th> <th colspan="2">WEEKDAY (MON. – FRI.)</th> <th colspan="2">WEEKEND (SAT. – SUN.)</th> </tr> <tr> <th>TIME</th> <th>TEMP.</th> <th>TIME</th> <th>TEMP.</th> </tr> </thead> <tbody> <tr> <td>Period 1 (Comfort)</td> <td>06.00 waken</td> <td>20°C</td> <td>06.00 waken</td> <td>20°C</td> </tr> <tr> <td>Period 2 (Economy)</td> <td>08.00 leave</td> <td>15°C</td> <td>08.00 leave</td> <td>20°C</td> </tr> <tr> <td>Period 3 (Comfort)</td> <td>11.30 home</td> <td>15°C</td> <td>11.30 home</td> <td>20°C</td> </tr> <tr> <td>Period 4 (Economy)</td> <td>13.30 leave</td> <td>15°C</td> <td>13.30 leave</td> <td>20°C</td> </tr> <tr> <td>Period 5 (Comfort)(1+2)</td> <td>17.00 home</td> <td>22°C</td> <td>17.00 home</td> <td>15°C</td> </tr> <tr> <td>Period 6 (Economy)(3+4)</td> <td>22.00 bed</td> <td>15°C</td> <td>22.00 bed</td> <td>15°C</td> </tr> </tbody> </table>	Time display	WEEKDAY (MON. – FRI.)		WEEKEND (SAT. – SUN.)		TIME	TEMP.	TIME	TEMP.	Period 1 (Comfort)	06.00 waken	20°C	06.00 waken	20°C	Period 2 (Economy)	08.00 leave	15°C	08.00 leave	20°C	Period 3 (Comfort)	11.30 home	15°C	11.30 home	20°C	Period 4 (Economy)	13.30 leave	15°C	13.30 leave	20°C	Period 5 (Comfort)(1+2)	17.00 home	22°C	17.00 home	15°C	Period 6 (Economy)(3+4)	22.00 bed	15°C	22.00 bed	15°C
Time display	WEEKDAY (MON. – FRI.)		WEEKEND (SAT. – SUN.)																																					
	TIME	TEMP.	TIME	TEMP.																																				
Period 1 (Comfort)	06.00 waken	20°C	06.00 waken	20°C																																				
Period 2 (Economy)	08.00 leave	15°C	08.00 leave	20°C																																				
Period 3 (Comfort)	11.30 home	15°C	11.30 home	20°C																																				
Period 4 (Economy)	13.30 leave	15°C	13.30 leave	20°C																																				
Period 5 (Comfort)(1+2)	17.00 home	22°C	17.00 home	15°C																																				
Period 6 (Economy)(3+4)	22.00 bed	15°C	22.00 bed	15°C																																				
External Temp. Display	Press and hold the  for 5 sec. to display the temp. of external sensor(if with).																																							

*Notes: During the thermostat in wifi connected status, it runs the programmable schedule process made from APP prior to that of thermostat. i.e. The programmable schedule only can be carried out if there is no Wifi connection between thermostat and smartphone/tablet PC.*

**Installer Set-UP Process (ISU)**



The installation personnel with non-professional training shall not perform this operation!  
During thermostat power off, Press these 2 buttons M &  simultaneously and hold for 5 seconds to enter ISU process. Press   to adjust the configurable parameter value, and press M to switch to next parameters. The ISU process will automatically exit and be confirmed after 5 seconds with no operation.

Parameter	Function	Configurable Value	Default
1	Temperature calibration	-7°C to +9°C (internal sensor)	-1
2	Fan Control Type	00:When room temp. reaches set point, the fan turns off 01:When room temp. reaches set point, the fan turns to low	00
3	Keypad Lock type	00: = All buttons will lock except the Power button 01: = All buttons will lock	01
4	Heating/Cooling	00: Cool only 01:Heating and Cooling	01
5	Min. set-point limit	5°C - 15°C	05
6	Max. set-point limit	15°C - 45°C	35
7	12/24 hours format	00:12h 01:24h	01
8	Temperature Display	00: display both set-point and room temp. 01: display set-point only	00
9	Economy Mode	00: Normal mode 01: Energy Saving mode	00
A	Heating Economy Temperature	10°C - 30°C	20
B	Cooling Economy Temperature	10°C - 30°C	26
C	Dead Zone	1°C to 5°C (Switching differential)	1

## Warranty



- Products are warranted for 2 full year (checking and repairing services) from the date of purchase which products are not being damaged by any man-made factors.
- Service outwith the warranty period may incur an extra charge.
- More details please contact with Hotowell directly.

**Wifi Connection**

**Step 1- Download and Install APP**

Use your smart phone or tablet PC to scan the QR code below or Search **“SMART LIFE”** in the app store /Google play to download and install APP .



App Icon



For ios system



For Android system

**Step 2- Register your account**

- Open **“SMART LIFE”** application, click **“Allow”** on the pop up notification dialog(fig 2.1)
- Press **“register”** button on the register page(fig2.2)
- Select your region and type in your phone No. or email (fig 2.3) then you may get a verification code. Type in your password and confirm (fig 2.4) to complete your registration.
- If you already have an account, please just log in.

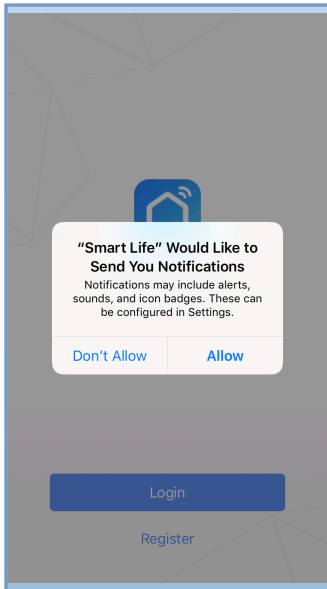

fig 2.1

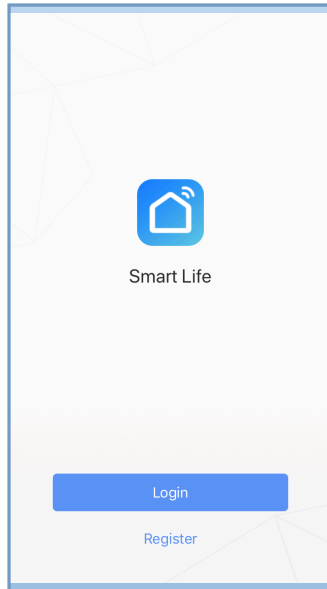

fig 2.2

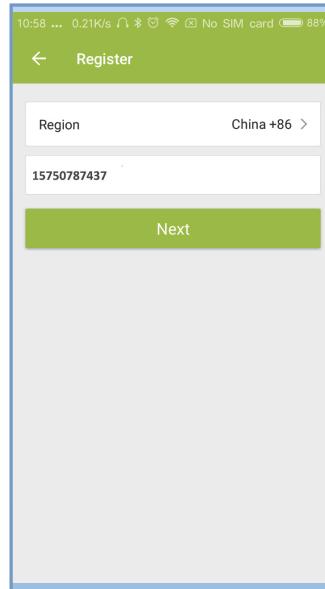

fig 2.3

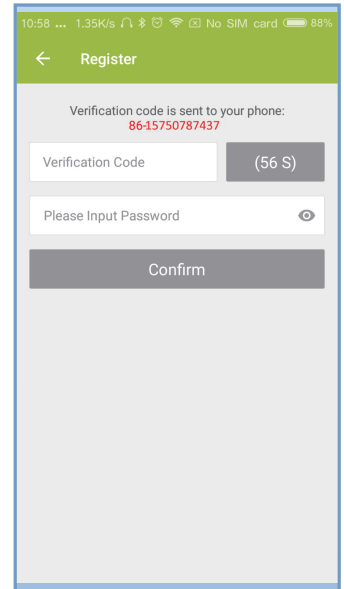

fig 2.4

**Step 3- Connect App with Thermostat**

**On the thermostat**

During power off status, press and hold the arrow icon ▼ for 8 sec until the connecting icon  appears on the thermostat screen and flashes once a sec.

**On the App**

- Press the “+” on the upper right corner of the page (see Fig 3.1) or “Add Device” to add “Thermostat”.
- Click “Confirm indicator rapidly blink” (Fig 3.2) then select your network and back to your App to enter the password of your wireless router(Fig.3.3) and confirm.
- The App will connect with the thermostat successfully. The connecting process takes 5~90 sec, the thermostat name can be editable once connected.(Fig.4.4)

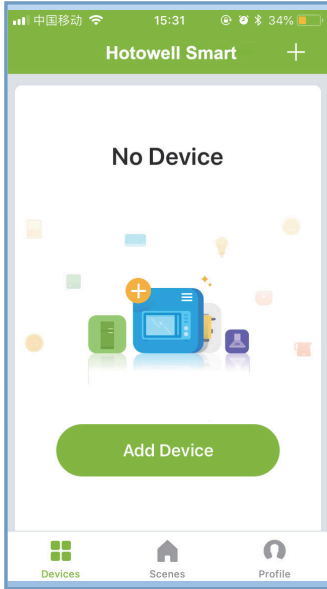

fig 3.1

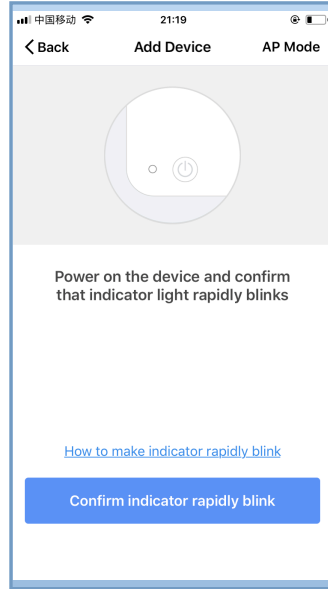

fig 3.2

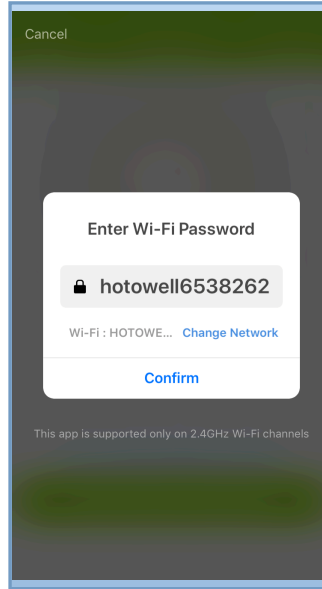

fig 3.3

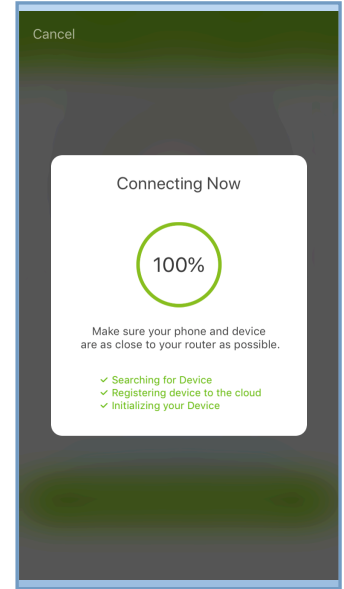

fig 3.4



**Alternative AP mode Connection**

**\*\*\*If the thermostat has already been connected under above steps, please ignore this process.\*\*\***

This **SMART LIFE** App is only supported on 2.4GHz Wi-Fi channels.

If the router does not be supported, or the wi-fi signal is weak or thermostat can not be connected as above steps, please try this AP mode connection process.

**On the thermostat**

- During power off status, press and hold the arrow icon ▼ for 8 sec until the  appears on the thermostat screen and flashes once a sec.
- press and hold the arrow icon ▼ for 8 sec again, the icon  will flash once per 3 sec.(fig 4.1)

 indicates connecting from normal router mode.

 Indicates connecting from AP mode.

**On the App**

- Click “Confirm indicator slowly blink” (fig 4.1) then select your network and back to your app to enter the password of your wireless router (fig 4.2) and confirm. The app will go into the page(fig 4.3)
- Press “Connect now” to select the wifi signal Smart life-XXXX from the thermostat(fig 4.3).
- This AP mode connection process may typically take approx. 5~90 seconds to complete.
- The thermostat name can be edited after connection (fig 4.4).

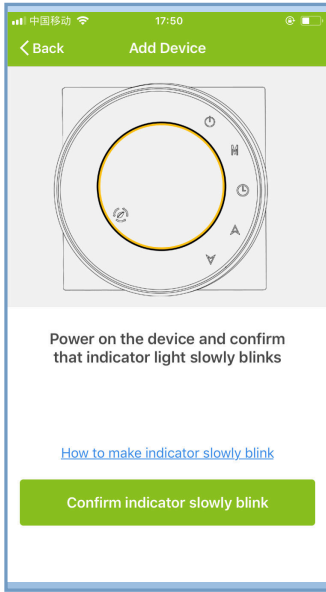

fig 4.1

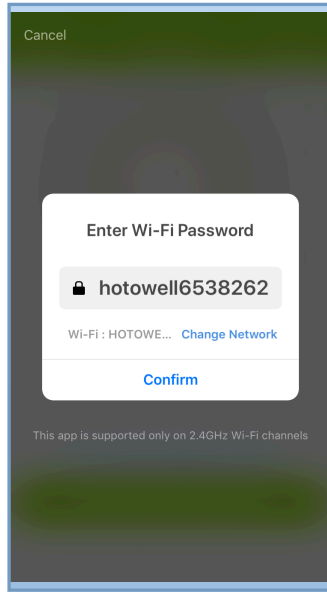

fig 4.2

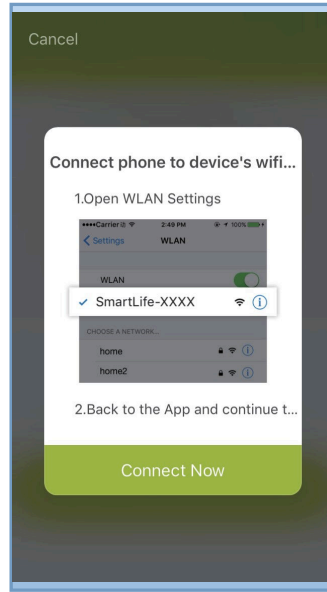

fig 4.3

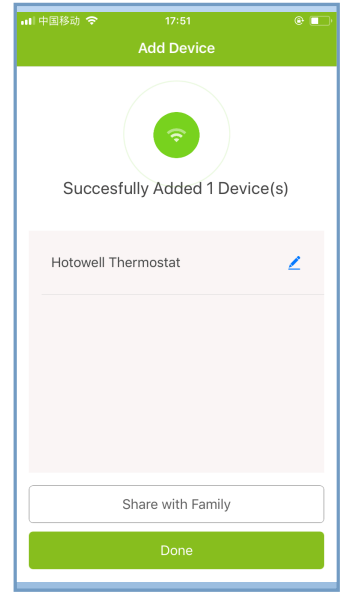

fig 4.4

**Operation Icons on APP**

App Icons	Functions
	Switch thermostat power On or Off
	Lock/Unlock Icon. Locked=Green, Unlocked=Grey
	Economy mode. The thermostat runs with the set-point configured as Parameter B in ISU Economy set-point=20°C in default.
	Thermostat runs in Manual Mode
	Thermostat runs in Programmable Mode
	System in Cooling Mode
	System in Heating Mode
	System in Ventilation Mode
	Fan Speed Indicator

**Programmable Schedule Setting**

When thermostat runs in programmable mode, click the “schedule setting” to switch to the schedule page, where you can simply configure the weekly programmable 5+2 schedule up to 6 period each day.

(Workdays=Monday~Friday, Weekend=Saturday and Sunday)

Click “Complete” to save the configuration.

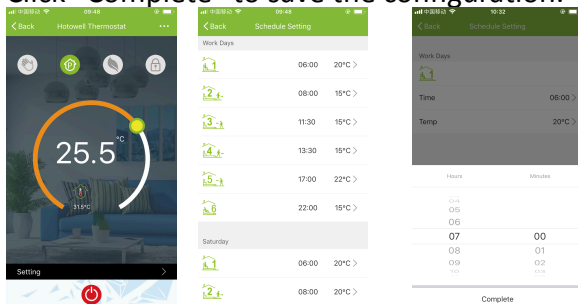



## Group Control and Info. Modify

- Press the menu button as fig 6.1, then click “Create Group”. Select all the rooms you want and confirm.(fig 6.2 and fig 6.3), edit the group name or ungroup as fig 6.3 and fig 6.4
- Group Control allows to control all thermostats(+∞ units) configuration in the group at the same time.



fig 6.1

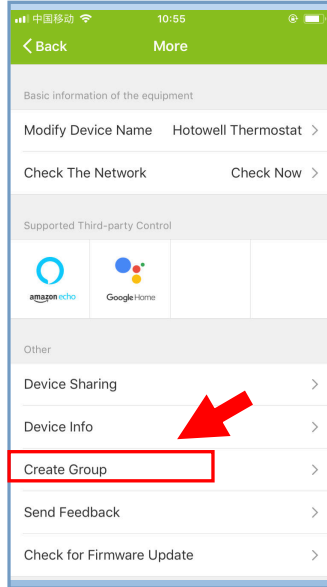

fig 6.2

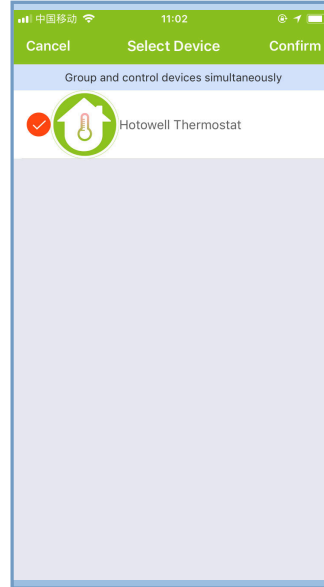

fig 6.3

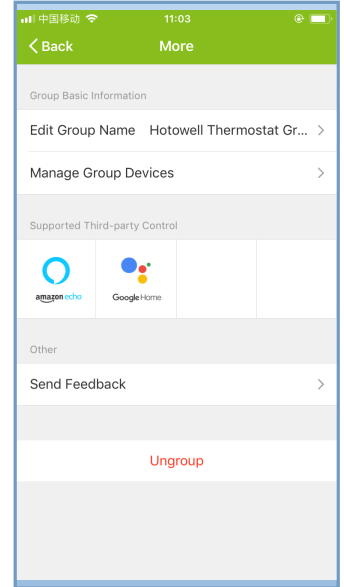

fig 6.4

## Share Thermostat with Others

- Method 1: Click “Share with Family” as fig 4.4.
- Method 2: Click “Profile”>”Sent”>”Add”>Switch on the device>”Share with New Member”>Type in the telephone number you would like to share with.
- Method 3:Home page of the device>Menu(as fig 6.1)>”Device Sharing”>”Add”>>Type in the telephone number you would like to share with.

## Work with 3rd party Echo Control

Click “Profile”>”Integration”>Select amazon echo/Google Home/IFTTT>”Use Now”  
Details as below fig 7.1 and 7.2.

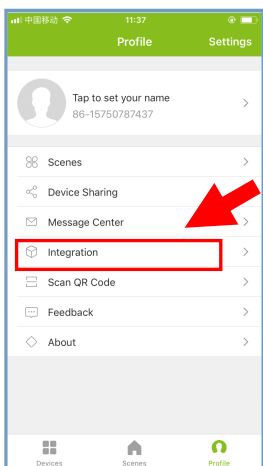

fig 7.1

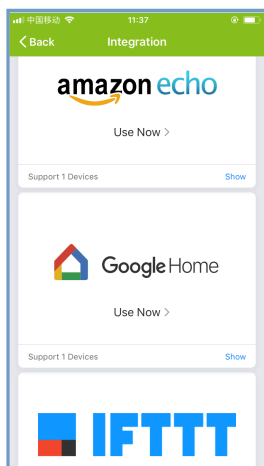

fig 7.2



## Customize Scene

- This process is to customize your own personal scenes to suit your needs, for example, set your home temperature automatically when you come back home.
- There are 4 scenes in default setting, and can be added/deleted at will.
- Here set an example of a specific scene: “leave home for holiday” and turn on the thermostat when temperature lower than 5°C
- Scenes(fig 8.1)>+>Enter a name for the scene(fig 8.2)>Add a condition(Below 5°C as fig 8.3)>Add a Task(fig 8.4)>Save

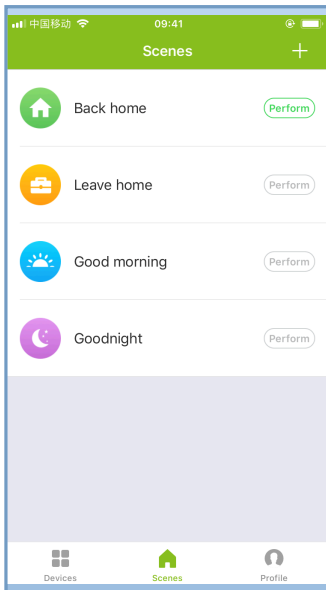

fig 8.1

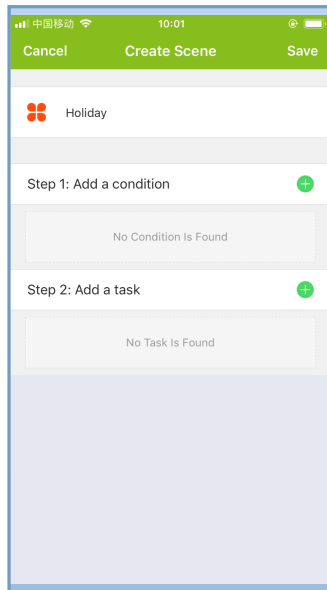

fig 8.2

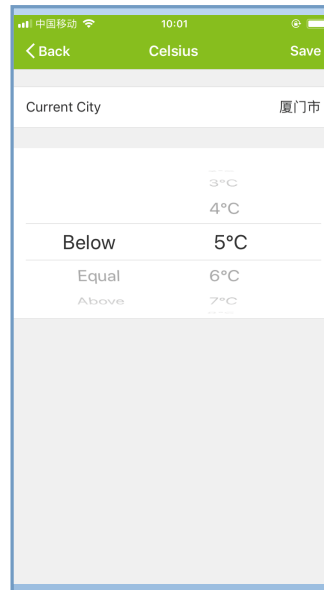

fig 8.3

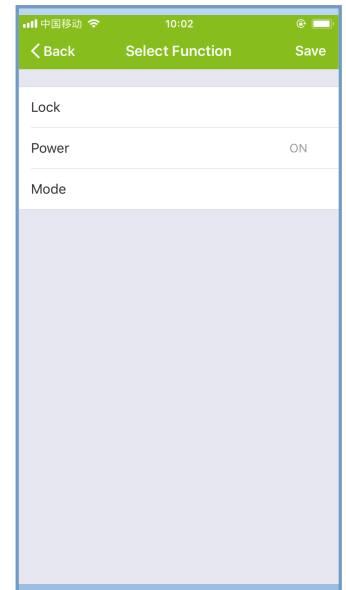

fig 8.4

## Trouble Shooting

No.	If...	Then...
1	Power is on but without display.	<ul style="list-style-type: none"> <li>■ Check if the terminals between LCD panel and Relay/Power Module is loosen.</li> </ul>
2	Without output but display works.	<ul style="list-style-type: none"> <li>■ Use a new LCD panel or new Relay/Power Module for Replacement</li> </ul>
3	Room Temp. on display is not correct	<ul style="list-style-type: none"> <li>■ Do temperature calibration in parameter in ISU</li> </ul>
4	Heating system does not respond	<ul style="list-style-type: none"> <li>■ Set the mode to heating by press-ing the M button.</li> <li>■ Make sure the temperature is set above the room temperature.</li> <li>■ Make sure “heat on” icon shows on the display.</li> <li>■ Wait 5 minutes for the system to respond.</li> </ul>
5	The M or Increase/Decrease button doesn't work	<ul style="list-style-type: none"> <li>■ Make sure keypad is unlocked.</li> <li>■ Check that thermostat is on.</li> </ul>

**Notice: Hotowell reserves all the right for the final explanation. The manual is subject to change without further notice.**